

Impression Panel Instruction Sheet

SIZE: 16"x20"/18"x24"/24"x24"
24"x30"/24"x36"/30"x30"
30"x40"/36"x36"/36"x48"

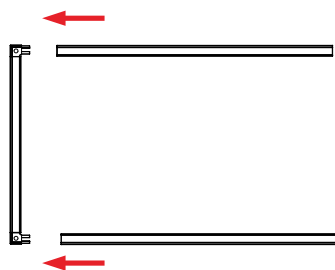

1. Attach the top and bottom horizontal bars to the left vertical bar.

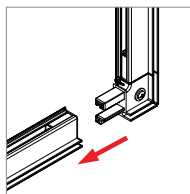
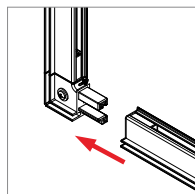
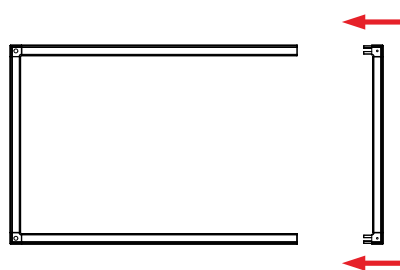

2. Attach the right vertical bar.

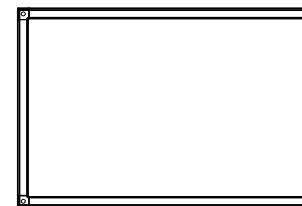

3. Frame is assembled.

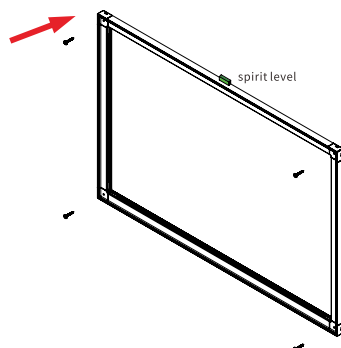
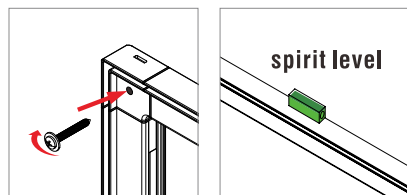

4. Secure frame to the wall using spirit level and screws (included).

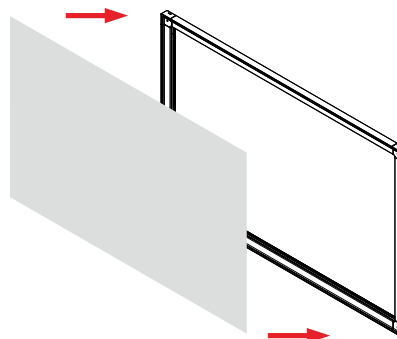

5. Install SEG graphics.

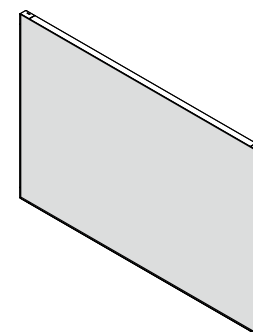

6. Installation is complete.